

MultiMedia

Classwork 04-23-18

Today's Objectives:

By the end of the class period students should be able to say:

1. **I CAN use the ellipse tool to create circles and elliptical shapes.**
 2. **I CAN use the gradient mode in the fill options to create desired effects**
 3. **I CAN use the pen tool to create objects in the drawing**
-

► Open Fireworks

1. Click **File New**
2. Width – 500 pixels
3. Height – 500 pixels
4. Resolution – 72 pixels – best for WEB images
5. Canvas Color – should be transparent
6. SAVE file
 - a. File > SAVE AS
last name, first-Smiley



Smiley Face in Fireworks Tutorial

1. Start off by using your ellipse tool to create a good sized circle.

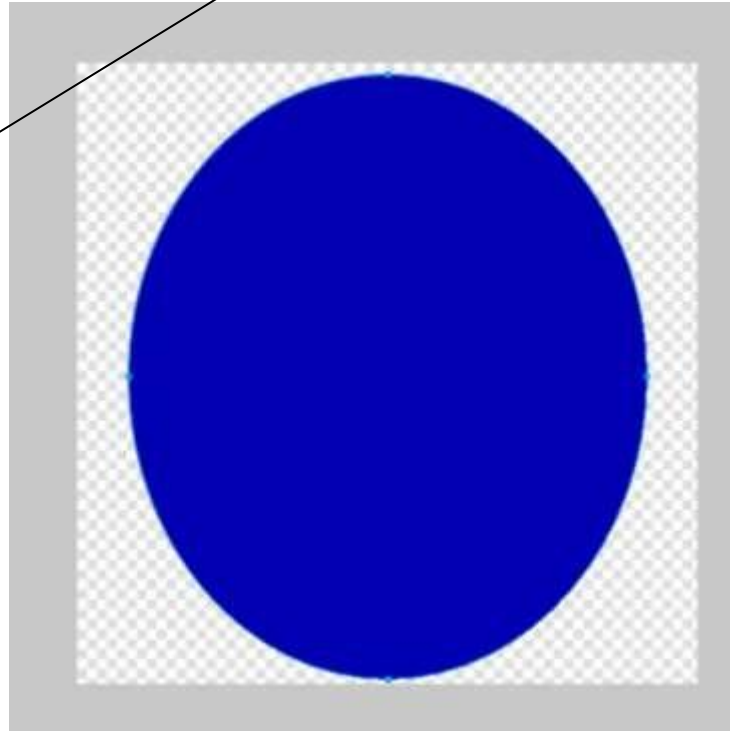
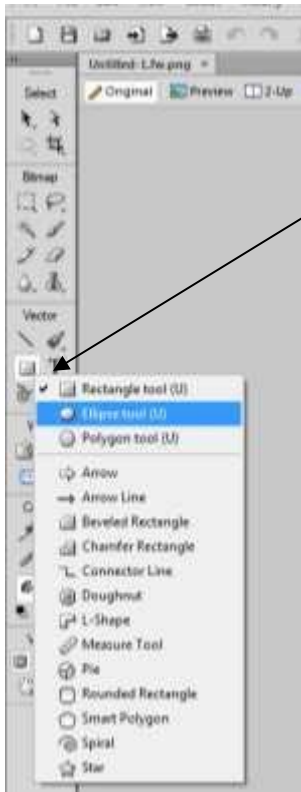

2. In your properties tab, change the fill mode to [gradient](#), and the gradient mode to [radial](#).

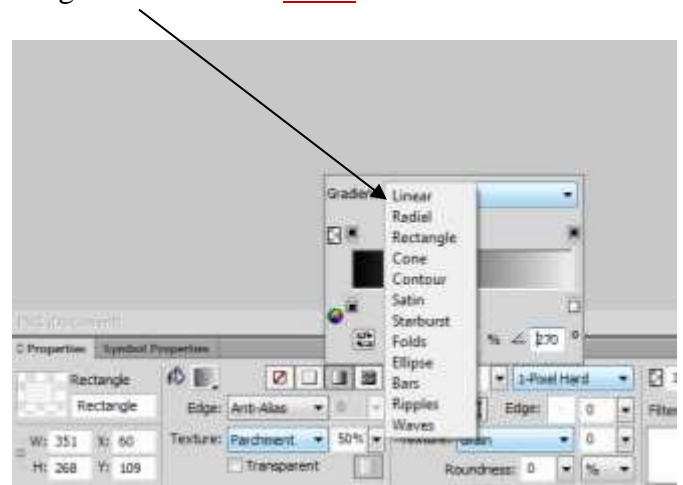
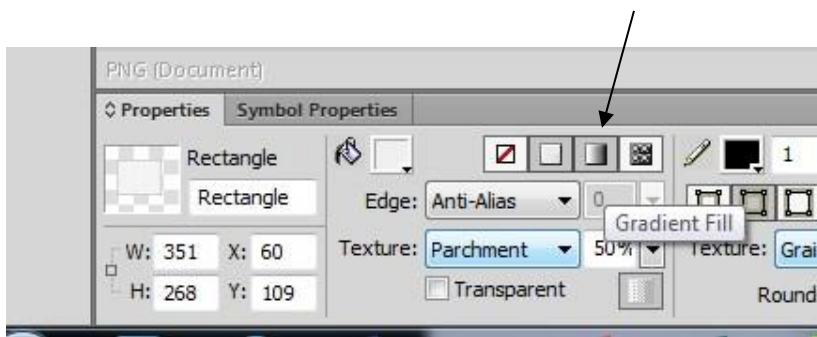

3. Change your gradient colors to a light yellow and a medium orange.

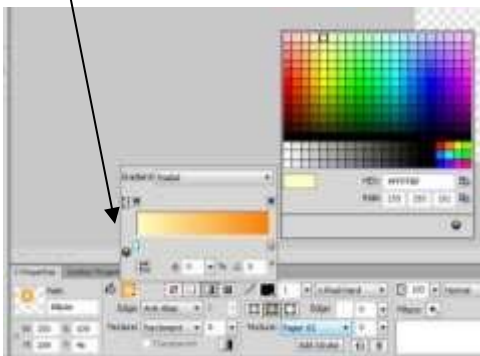

- i. Position your [gradient handle](#) so that the light yellow starts towards the top and radiates orange outwards.

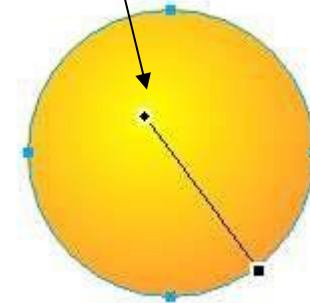

4. Use your ellipse tool to create an elliptical shape similar to the one shown below. We are going to use a gradient again, this time however, change the gradient mode to linear and the colors to white and gray. Position the gradient so that the gray starts at the top.

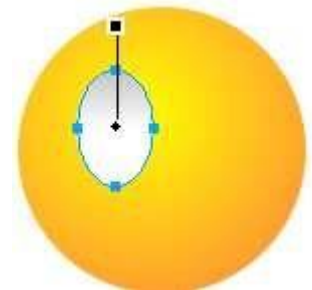

5. [Duplicate](#) this shape by pressing Ctrl+C and the Ctrl+V to paste it.
Move your duplicate eye to the right of your original, as shown below.



6. Now we are going to create some pupils. Zoom in by pressing Ctrl+"+" and use your ellipse tool to create a

small circle. Change your gradient mode from linear back to radial, and change the colors to black and medium gray. Position your gradient so that the gray starts in the middle and radiates outwards. Position your pupil similar to the way I have mine below.



7. Duplicate your pupil just like we did with the eye sockets, and place it in your duplicate eye socket. 8. Use the Vector Path tool to draw some eyebrows

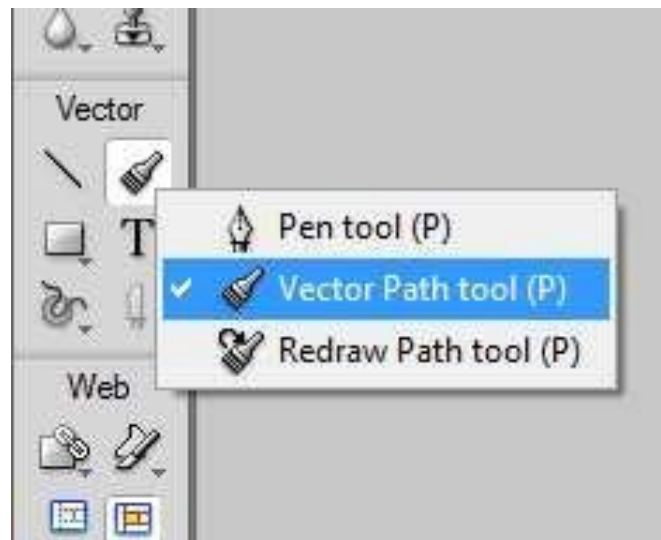

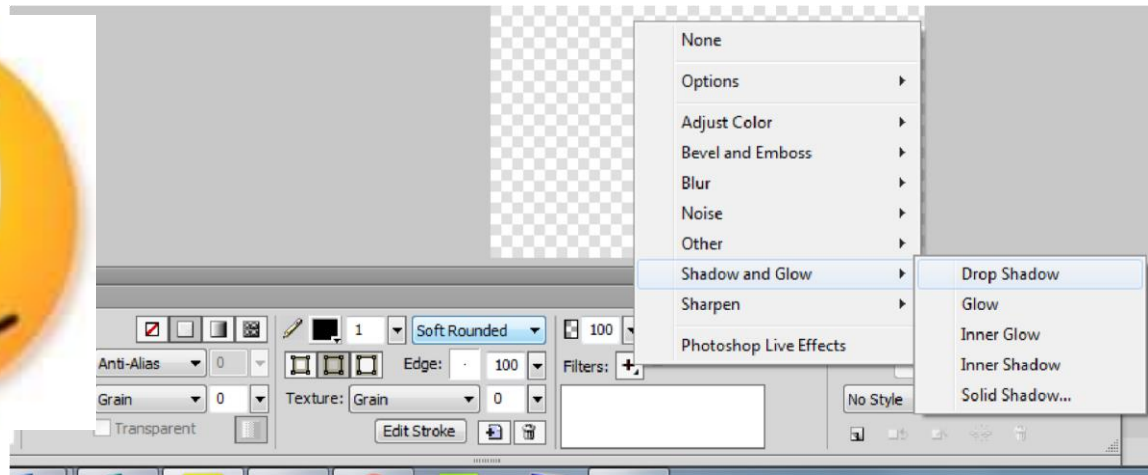

9. Create a small circle with a radial gradient of yellow to orange for the nose, and add a drop shadow.

10. SAVE Again: ### last name, first name-Smiley

11. Change the save as type to JPEG and save again. Then Drop off only the JPEG version when complete!