

Triangle Congruency Project

GRADING

Grading will be based on the following criteria: neatness, creativity, structural stability, having a key that correctly identifies the congruent triangles present in your structure, and having multiple types of congruent triangles within your structure. A project that earns a perfect score will be solidly built, colorful, have various shapes and sizes of congruent triangles, and have a key that accurately identifies the triangles in the structure.

This project is due **Friday, January 8, 2016**. Your grade will be lowered by one full letter grade for each day that the project is late. If you are absent from class on the due date, it must be an excused absence to prevent your grade from being lowered. You are expected to turn in your project the first time you come to school on or after January 8th, 2016. Example: You have Geometry 2nd hour, you were excused from 1st and 2nd, and you check in after 2nd hour. You will still be expected to turn the project that day, during lunch, between classes, or after school.

Various examples of truss bridge designs below:

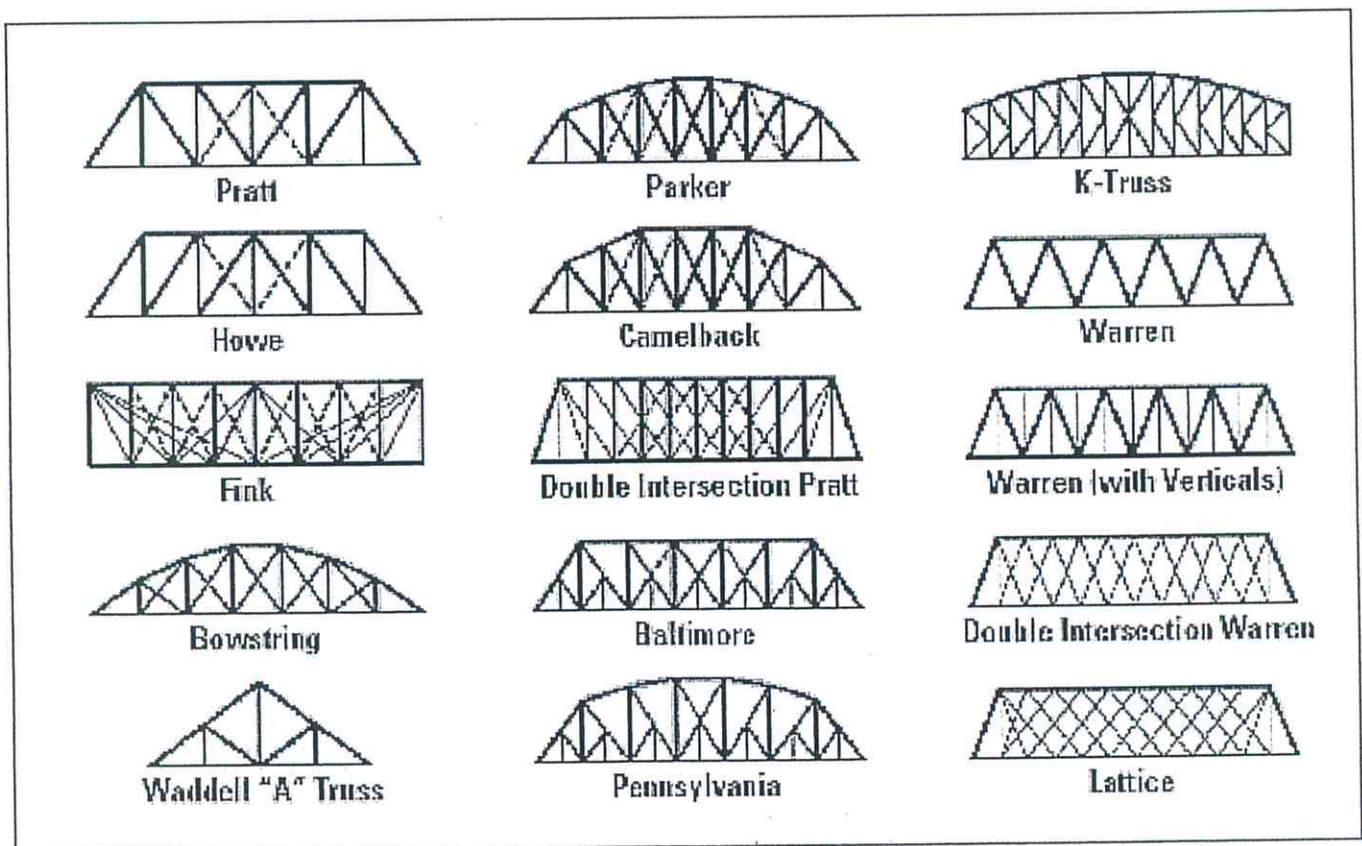

Additional ideas and examples can easily be found by Googling "Popsicle Sticks Bridge Project Designs" and looking at images!!